

OR
ENDOSCOPY
INTENSIVE CARE

TECHNICAL DATA:

Model	MEDIBOOM
Load max.	Single up to 640 kg / dual up to 300 kg
Brake type	Electromagnetic passive brake
System	Rated voltage: AC 100-240 V, rated power 200 W
Rated voltage SurroundLED	AC 12V
Rated voltage BrakeGuide	AC 24 V
Operating weight	Arm 800: 29 kg; extensionarm 1000/ 800: 56 kg
Colours	Arm: RAL 9002, RAL 9010; Ceilingtube and droptube: RAL 9022 End caps: on request
Test symbol	UL
Mark of conformity:	CE

TECHNICAL DATA & LOADS:

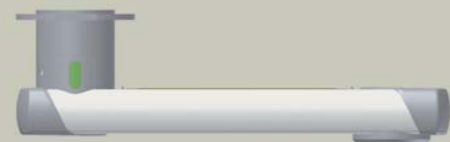

LENGTH	LOADS
600 _{mm}	640 kg
800 _{mm}	470 kg
1.000 _{mm}	370 kg
1.200 _{mm}	300 kg

LENGTH	LOADS
600 / 600 _{mm}	300 kg
600 / 800 _{mm}	260 kg
800 / 800 _{mm}	220 kg
800 / 1.000 _{mm}	190 kg
1.000 / 1.000 _{mm}	170 kg
1.200 / 1.000 _{mm}	150 kg

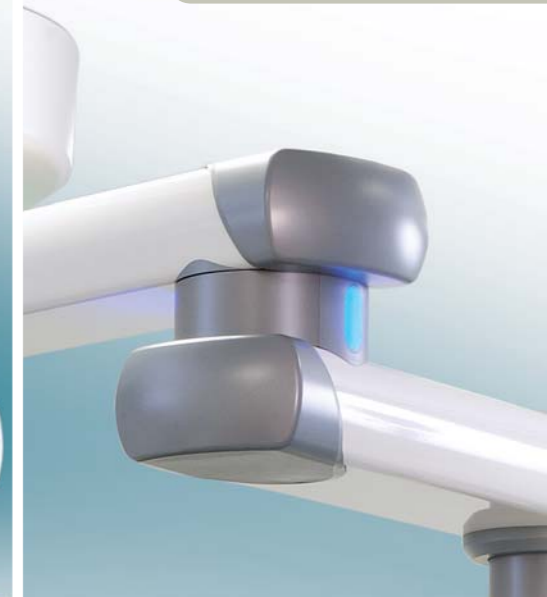

MEDIBOOM

The next generation for OR, Endoscopy and Intensive Care



Movement - light as a feather

ONDAL Industrietechnik GmbH
Wellastraße 6
36088 Hünfeld
Germany
Telephone +49 (0) 6652/81-0
Fax +49 (0) 6652/81-392
E-Mail info@ondal.de

Ondal USA Inc.
540 Eastpark Court, Suite A
Sandston, VA 23150
USA
Toll-free: +1 (866) 663 2587
Telephone +1 (804) 532 1440
Fax: +1 (804) 532 1494

ONDAL Industrietechnik GmbH
Shanghai Representative Office
Room 3906, Ciro's Plaza,
No. 388 West Nanjing Road
Shanghai, PR China
Telephone +86 21 63345001
Fax +86 21 63345003

Data and content are subject to change.
Validation of final product after combination with MediBoom is customer's responsibility.
11/2010



MEDI BOOM THE NEXT GENERATION



VALUABLE ADVANTAGES FOR THE USER

USER-FRIENDLY DESIGN

The *MediBoom* has been designed with user requirements in mind: concealed fasteners provide a smooth surface for easy cleaning. The *MediBoom* can be easily adapted to your specific corporate design. Numerous customization options are available, from using your corporate color scheme on the end caps, to printing your company logo on your *MediBoom*.

E-BRAKE

SAFE AND FLEXIBLE IN AN EMERGENCY (1-3)

The *E-Brake*, the innovative electromagnetic passive brake system of the *MediBoom* keeps the system safely positioned even during a power outage. The *E-Brake* is also designed so as to allow manual repositioning at any time.

SURROUNDLED C + F

VARIABLE LIGHTING (4+5)

Dimmable LED lights serve as an indirect light source in the OR and as an orientation aid for medical staff in the ICU. The *SurroundLED C* feature in the upper extension arm of the *MediBoom* provides comfortable lighting on the ceiling. Upon request, the bottom of the service head can be equipped with the *SurroundLED F* to light the floor area.

BRAKEGUIDE

DEFINITELY EASIER TO USE (1+3)

The LED color lighting system of the *BrakeGuide* virtually eliminates the risk of faulty operation.

The *BrakeGuide* provides visual feedback and shows where the brake was released. With this feature, the *BrakeGuide* offers a significant advantage over other systems and improves the safety and user-friendliness, especially in a dark OR environment.

MEDISOUND-SYSTEM

AMAZING SOUND QUALITY (6-8)

The *MediSound-System* is the first audio system approved for medical applications in the OR and ICU.

An iPod or an MP3 player can be easily connected to the docking station and controlled with the infrared remote control.

Four speakers in the service head or as an option, an external spherical speaker for advanced demands produce an amazing sound. In this way, the *MediSound-System* can help reduce patients' perception of pain and distract them from disturbing OR noises. It also improves the work environment for the surgical staff.

COMPELLING TECHNOLOGY

OPTIMIZED AND EASIER INSTALLATION

The new, innovative design of the *MediBoom* is impressive. Fasteners have been concealed from the exterior and interior restricting points have been eliminated. Cables can be easily installed through large openings.

The Plug-and-Brake system (5) is a particularly handy feature of the *MediBoom*. It allows for a speedier connection of the control panel to the Service Head by means of quick-action couplings. Large openings at the bearing points facilitate quick and easy cable installation. All system lines are equipped with coded plug connections for easy and safe installation.

E-BRAKE

STANDARD FEATURE AND MAINTENANCE FREE

The electromagnetic brake system called *E-Brake* is a standard feature of the *MediBoom*.

The previously required compressed-gas/air (Nitrogen or air) connection is no longer needed due to the electrical actuation of the *E-Brake*. This reduces infrastructure cost and ongoing maintenance issues with conventional air brakes. With normal operation there are no costs for replacement parts due to the maintenance-free design.

SMOOTH MOVEMENT OF BEARINGS

MediBoom is equipped with the most innovative bearing system for ceiling-mounted pendant systems. Loads up to 640 kg can be moved with ease. The integrated bearings have optimized running characteristics which allow the smooth repositioning of the system when the brake is released.

SPACIOUS ACCOMMODATION FOR A MODERN OR SYSTEM (9)

Modern ORs have to meet more sophisticated and complex requirements to allow high performance. For this reason, the extension arm and the bearings of *MediBoom* offer ample capacity for all current and future supply lines.

